



**S.N.D.T. Women's University**  
**Sir Vithaldas Thackersey College of Home Science**

**(Autonomous)**

NAAC Re-accredited 'A' Grade

UGC Honor - College with Potential for Excellence



SVT/Quotation/2019-20/171

Date: 15.05.2019

SUB: Quotation for Pathway in Students Hostel Landscape (Creation of Students Friendly Zone) under RUSA -2 Infrastructure grant at Sir Vithaldas Thackersey College of Home Science (Autonomous) SNDT Women's University, Sir Vithaldas Vidyavihar Campus, Juhu Tara Road, Santacruz (West), Mumbai.

Madam /Sir,

Sealed quotations are invited for Pathway in Students Hostel Landscape (Creation of Students Friendly Zone) under RUSA -2 Infrastructure grant at Sir Vithaldas Thackersey College of Home Science (Autonomous) SNDT Women's University, Sir Vithaldas Vidyavihar Campus, Juhu Tara Road, Santacruz (West), Mumbai. Interested vendors are requested to submit their quote in the format given in Annexure A on company letter head. Quotation should be submitted to The Principal, Sir Vithaldas Thackersey College of Home Science (Autonomous) SNDT Women's University, Sir Vithaldas Vidyavihar Campus, Juhu Tara Road, Santacruz (West), Mumbai on or before 22<sup>nd</sup> May , 2019 (before 4.00 p.m.)

Sir Vithaldas Thackersey College of Home Science (Autonomous), SNDT Women's University, Santacruz (West), Mumbai reserves the right to reject any or all quotations without assigning any reasons thereof.

  
Dr. Jagmeet Madan  
(Principal)

(Offer should filled on letter head)  
Annexure A

To,  
The Principal,  
Sir Vithaldas Thackersey College of Home Science (Autonomous),  
SNDT Women's University,  
Juhu, Santacruz (West),  
Mumbai - 400 049.

SUB: Quotation for Pathway in Students Hostel Landscape (Creation of Students Friendly Zone) under RUSA -2 Infrastructure grant at Sir Vithaldas Thackersey College of Home Science (Autonomous) SNDT Women's University, Sir Vithaldas Vidyavihar Campus, Juhu Tara Road, Santacruz (West), Mumbai.

Sir / Madam,

With reference to subject cited above we would like to furnish our quote with best rate possible as below :

SR.N O	PARTICULARS	UNIT S	QTY	RATE Per Sqft	AMOUNT
1	LANDSCAPING :-				
1.1	<b>Pathway Flooring:</b> 2'X2' , approximately 25mm thk Kotah stone fixing on pathway demarcated in drawing, to be laid as per design, using 1:4 cement mortar, with machine cutting as required, joints treated with neat laticrete with an admixture of pigment as per drawing, to be laid as per plan complete, (base rate 35/-)	Sqft	1800 Sqft		
1.3	<b>Floor Polishing :-</b> Machine cutting as per required, joints treated with neat cement slurry with an admixture of pigment to match the shade of stone for floor mirror polishing.	Sq.Ft	1800 Sqft		
				Amount (Rs.)	-
				Add:- GST @ 18%	-
				Total Amount (Rs.)	-

All the terms and conditions given in notifications Should be studied thoroughly and accepted fully.

Thanking you,

Yours truly,

Name of the Company  
Signature of the Proprietor  
Date :

- Note : Please enclose
1. Self attested GST number copy ,
  2. Self attested PAN number copy,
  3. Declaration on the company letter head if GST is not applicable.

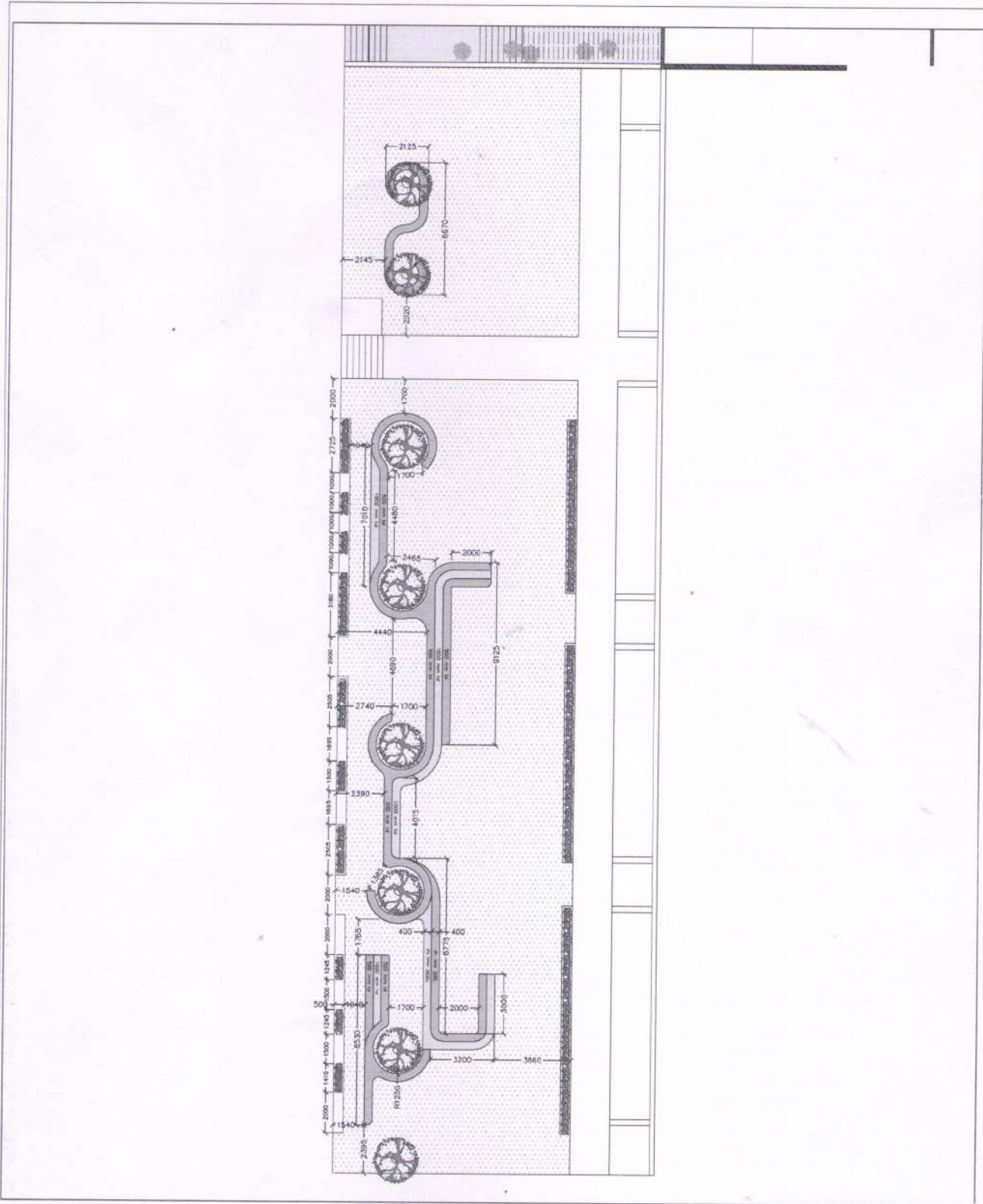

Client : SNDT college Juhu, Mumbai.	Issued by: KH	Dwg. No: SNDT_EL01	Rev. No: 00
Project : SNDT college Juhu, Mumbai.	Checked by: SM	Proj. Code: SNDT_EL	Rev. Date: 14.05.2019
Dwg. Name : Landscape layout		Scale:	Notes: